



PER MONTH

£4,000 Per Month
Shacklewell Street

London, E2 7EG

Located on a quiet residential street is this basement, 4 bedroom apartment set over 1500 square feet.

The property features a enclosed entrance. There is a large reception room with open plan kitchen, 4 bedrooms, shower room and separate W/C.

Brick Lane and Columbia Road Flower Market are both just a short walk as well both Shoreditch High Street and Liverpool Street Stations being close by.

Unfurnished

5 weeks deposit: £4615.38

Council Tax: Band E

Available middle of July





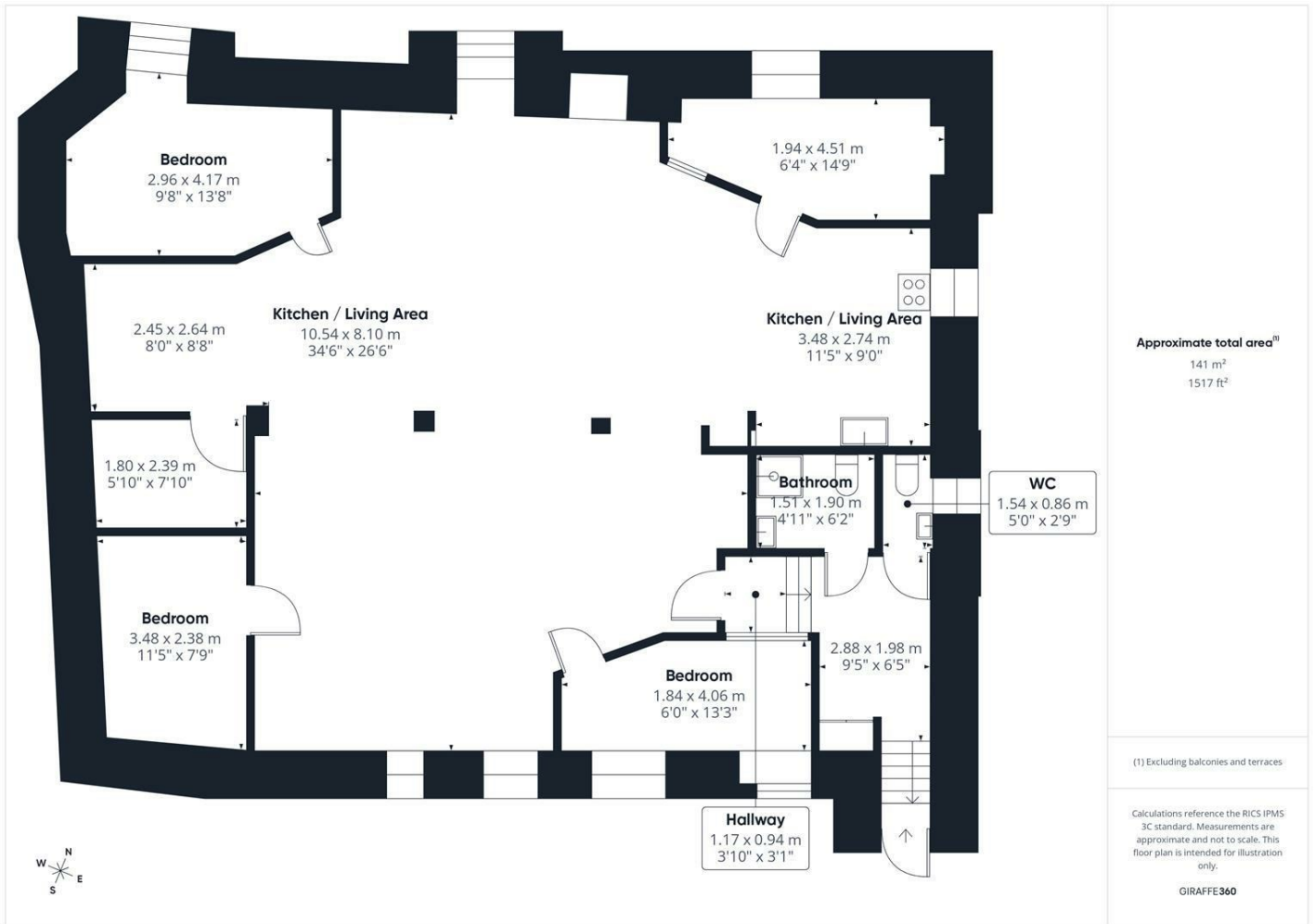

Energy Efficiency Rating		
	Current	Potential
Very energy efficient - lower running costs		
(92 plus) A		
(81-91) B		
(69-80) C	73	80
(55-68) D		
(39-54) E		
(21-38) F		
(1-20) G		
Not energy efficient - higher running costs		
England & Wales	EU Directive 2002/91/EC	

Agents Note: Whilst every care has been taken to prepare these particulars, they are for guidance purposes only. All measurements are approximate and are for general guidance purposes only and whilst every care has been taken to ensure their accuracy, they should not be relied upon and potential buyers/tenants are advised to recheck the measurements

<p>OFFICE ADDRESS 88 Cheshire Street London E2 6EH</p>	<p>OFFICE DETAILS 0207 739 6969 info@peachproperties.com www.peachproperties.com</p>
--	---